



Lid Stay, with joint, for wooden flaps

Soft & Silent

Product details

Area of application	for wooden flaps
Version	with joint, with angular bracket
Material	Steel, Housing: Plastic
Color/finish	Nickel plated
Lid material	
Opening angle	90 °
For cabinet width	900 mm
For cabinet height	300–900 mm
For lid weight	4 kg
Mounting	right and left hand use
Installation	Reversible, can be installed left or right

Supplied with

Mounting screws

Line drawings

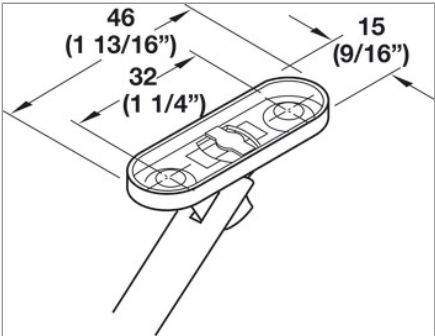
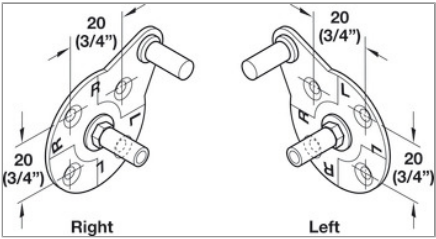
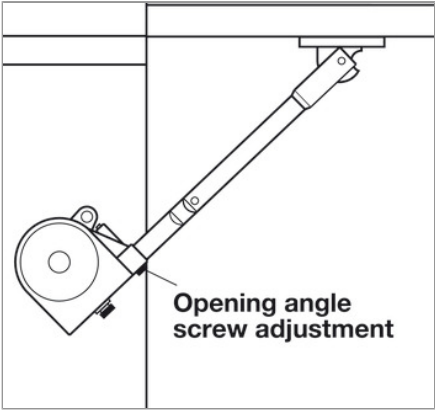
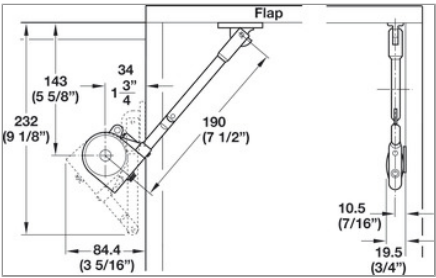

Mounting on the side panel

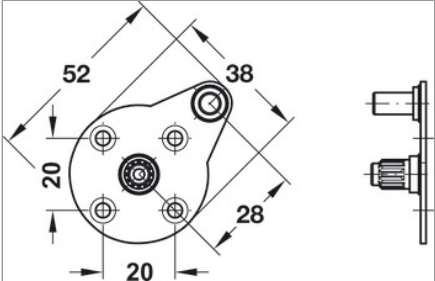
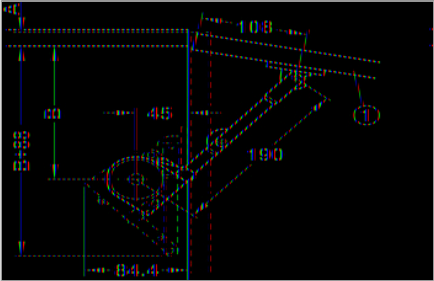
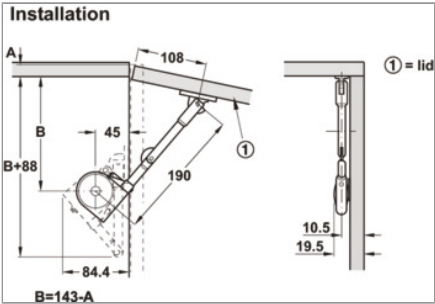
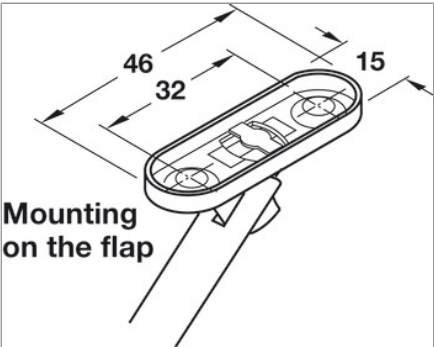
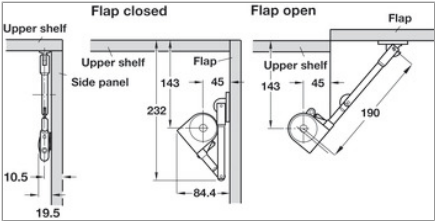
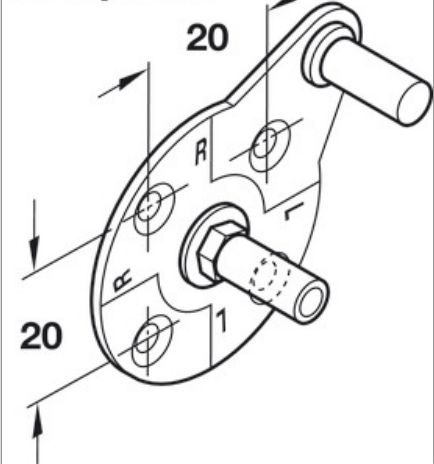

Item table (2)

Soft & Silent, Black

Item number
365.31.300

Soft & Silent, White

Item number
365.31.700