



## Cover cap, For Häfele Minifix® 15 Without Rim, From Wood Thickness 15 Mm

SW4 hexagon socket

### Product details

|                     |  |
|---------------------|--|
| Area of application | For Häfele Minifix® 15, without rim, from wood thickness 15 mm, SW4 and PZ2 hexagon socket |
| Version             | With plug  |
| Product Material    | Plastic  |
| For type of drive   | Hexagon socket SW4   |
| Head Ø              | 17.0 mm  |
| Head height         | 1.0 mm   |
| Shaft Ø             | 4.0 mm   |
| Shaft height        | 3.0 mm   |
| Installation        | For clamp fixing   |

### Additional information attributes

The colours shown are similar to RAL colours and are as close as possible to the actual standard colours. The colour shades may vary slightly due to production reasons.

### Installation drawings

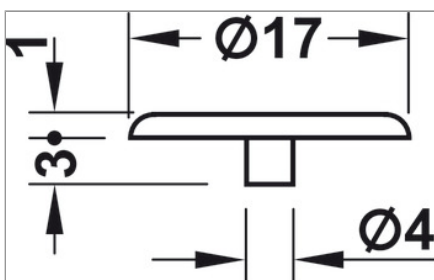

## Article table (11)

|   |                        |
|---|------------------------|
| SW4 hexagon socket, Pine coloured                           | Art. no.<br>262.24.055 |
| SW4 hexagon socket, Maple coloured S1074 / JPE34359-1       | Art. no.<br>262.24.149 |
| SW4 hexagon socket, Dark brown, RAL 8017                    | Art. no.<br>262.24.151 |
| SW4 hexagon socket, Brown, RAL 8007                         | Art. no.<br>262.24.153 |
| SW4 hexagon socket, Aluminium coloured, RAL 9006            | Art. no.<br>262.24.200 |
| SW4 hexagon socket, Black, RAL 9005                         | Art. no.<br>262.24.359 |
| SW4 hexagon socket, Brown beige, RAL 1001 / beige, RAL 1001 | Art. no.<br>262.24.475 |
| SW4 hexagon socket, Grey beige, RAL 1019                    | Art. no.<br>262.24.478 |
| SW4 hexagon socket, Dust grey, RAL 7037                     | Art. no.<br>262.24.550 |
| SW4 hexagon socket, Light grey, RAL 7035                    | Art. no.<br>262.24.555 |
| SW4 hexagon socket, White, RAL 9010                         | Art. no.<br>262.24.751 |