



Aluminium handle profile

For mounting between worktop and front panel beneath

Product details

Depth	23.0 mm
Width	49.3 mm
Material	Aluminium
Suitable for	Handle-less fronts
Installation	Between worktop and front
Area of application	For front panels without handles, for mounting between worktop and front panel beneath

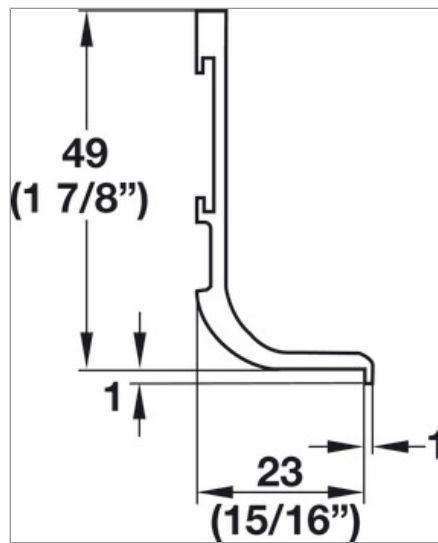
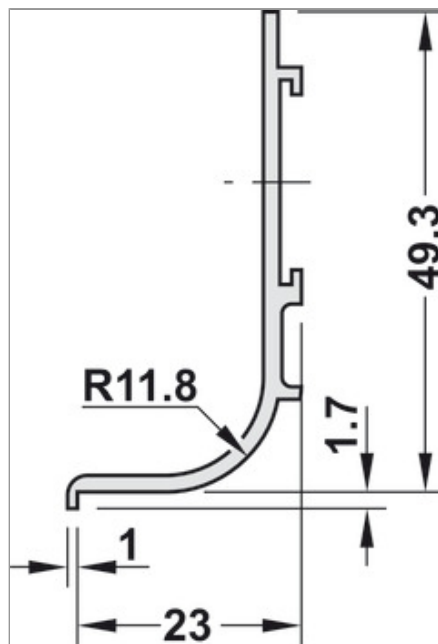

## Installation

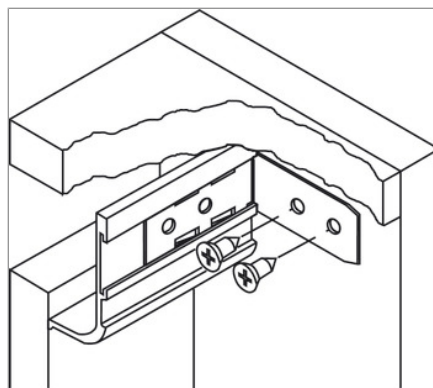
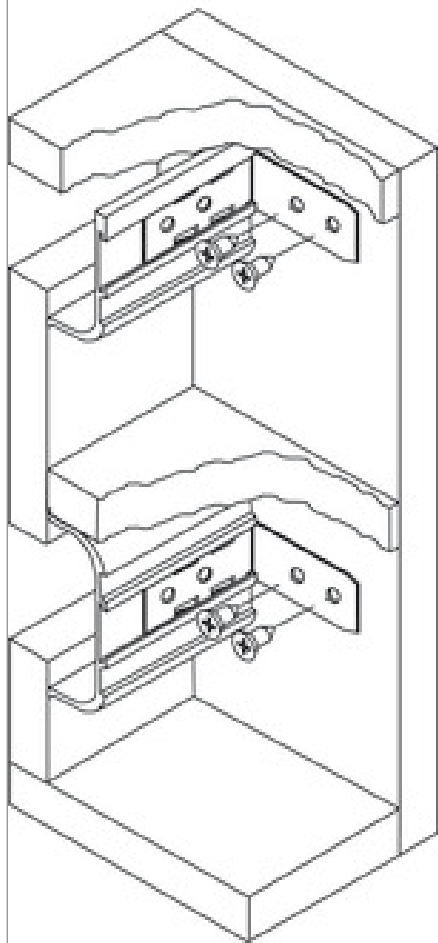

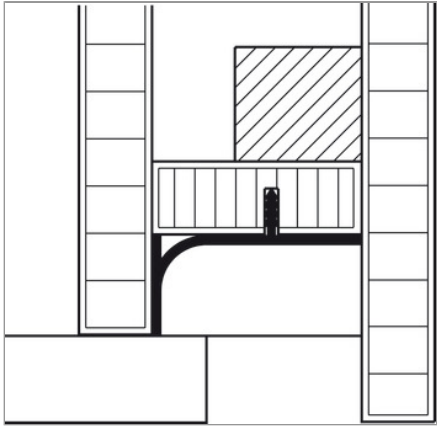

**Article table (7)**

For mounting between worktop and front panel beneath, matt black anodized (E6/C35), length: 2500 mm	Art. no. 123.37.301
For mounting between worktop and front panel beneath, matt black anodized (E6/C35), length: 5000 mm	Art. no. 123.37.306
For mounting between worktop and front panel beneath, Stainless steel coloured	Art. no. 126.37.001
For mounting between worktop and front panel beneath, Stainless steel coloured	Art. no. 126.37.006
For mounting between worktop and front panel beneath, Pure white, RAL 9010, powder coated	Art. no. 126.37.700
For mounting between worktop and front panel beneath, White	Art. no. 126.37.705
For mounting between worktop and front panel beneath, Silver coloured	Art. no. 126.37.900